

System No. FW-S-1022

February 10, 2014

Assembly Rating — 2 Hr

Joint Width — 4 In. Max

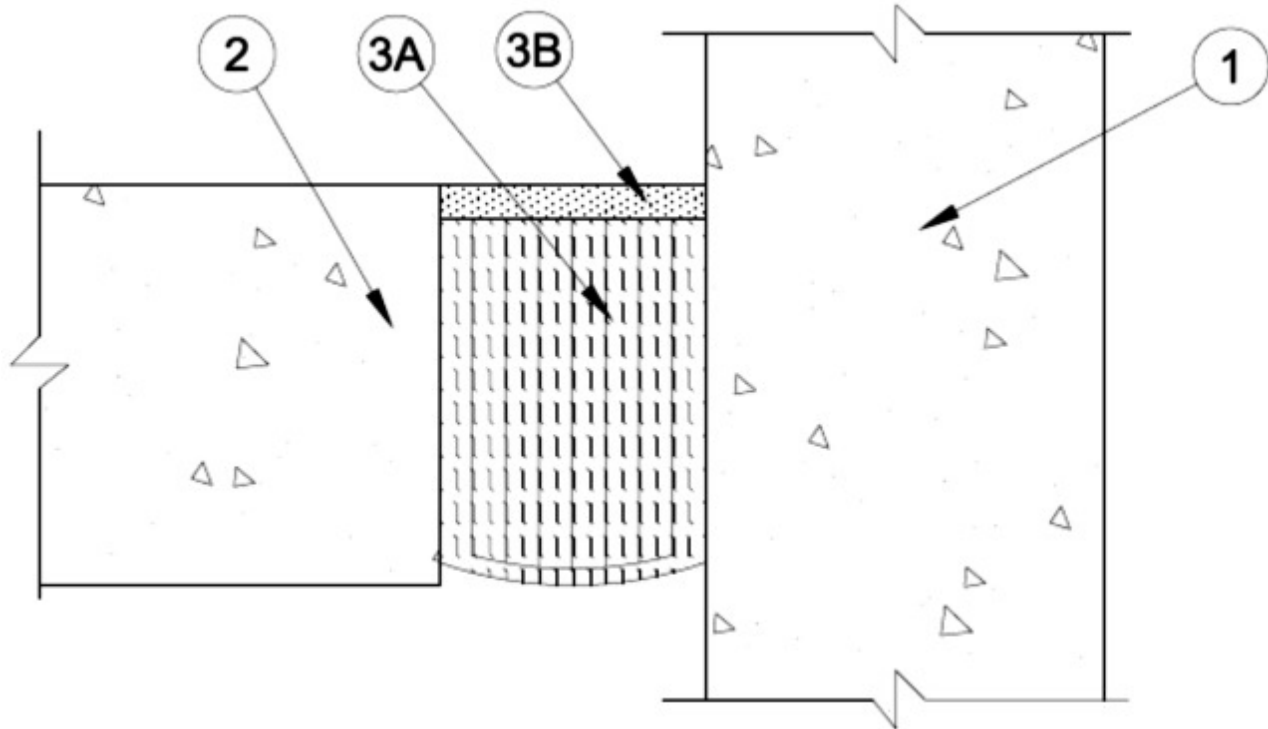

1. **Wall Assembly** — Min 4-1/2 in. (114 mm) thick reinforced lightweight or normal weight (100-150 pcf or 1600-2400 kg/m³) structural concrete. Wall may also be constructed of any UL Classified **Concrete Blocks***.

See **Concrete Blocks** (CAZT) category in the Fire Resistance Directory for names of manufacturers.

2. **Floor Assembly** — Min 4-1/2 in. (114 mm) thick steel-reinforced lightweight or normal weight (100-150 pcf or 1600-2400 kg/m³) structural concrete.

3. **Joint System** — Max separation between edge of floor and face of wall is 4 in. (102 mm). The joint system shall consist of the following:

A. **Forming Material*** — Min 11 in. (279 mm) width of forming material folded in half, compressed min 40 percent in thickness and friction fitted into opening as a permanent form. Forming material to be recessed from top surface of floor to accommodate the required thickness of fill material.

BACKER ROD MFG INC — ULTRA BLOCK®

B. **Fill, Void or Cavity Material* - Sealant** — Min 1/2 in. (13 mm) thickness of fill material applied within the joint, flush with top surface of floor.

RECTORSEAL — FS4000 Sealant, Metacaulk 835+, Biotherm 100

* Indicates such products shall bear the UL or cUL Certification Mark for jurisdictions employing the UL or cUL Certification (such as Canada), respectively.