



# System No. FW-S-1011

January 20, 1999

Assembly Rating — 2 Hr

Joint Width — 6 in. Max

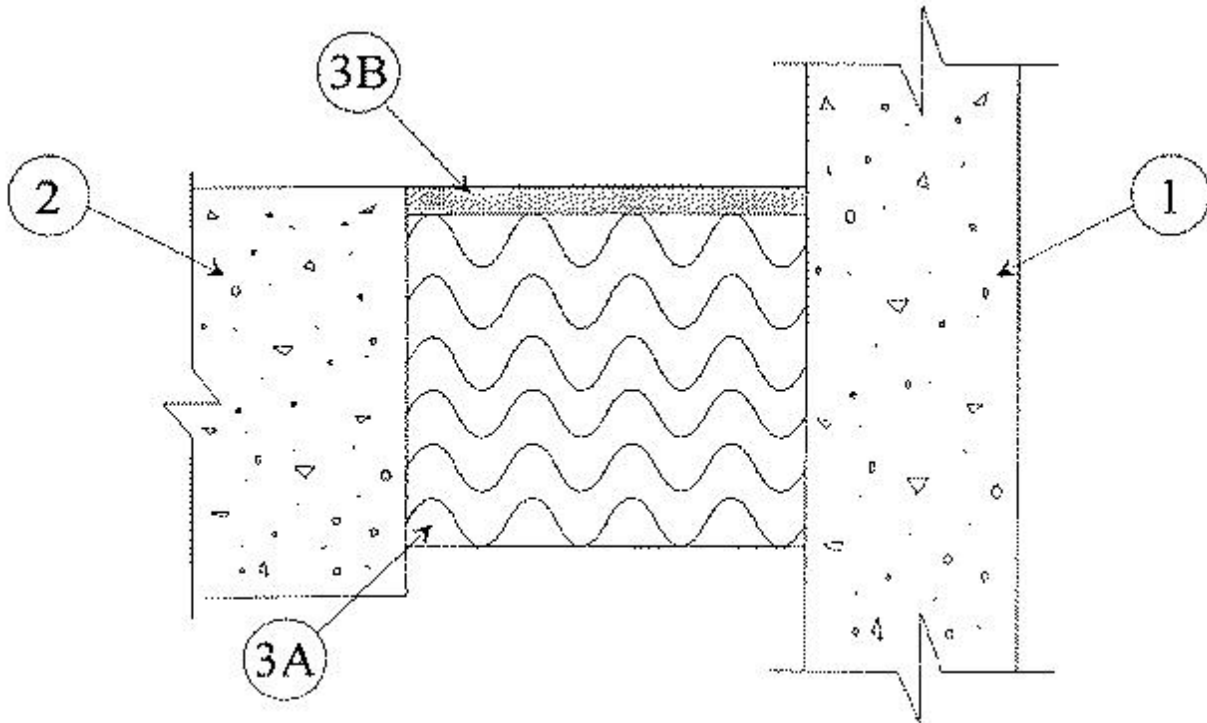

1. **Wall Assembly** — Min 4-1/2 in. thick reinforced lightweight or normal weight (100-150 pcf) structural concrete. Wall also may be constructed of any UL Classified **Concrete Blocks\***.

See Concrete Blocks (CAZT) category in the Fire Resistance Directory for names of manufacturers.

2. **Floor Assembly** — Min 4-1/2 in. thick reinforced lightweight or normal weight (100-150 pcf) structural concrete.

3. **Joint System** — Max width of joint is 6 in. The joint system shall consist of the following:

A. **Packing Material** — Min 3-3/4 in. thickness of min 4.0 pcf mineral wool batt insulation tightly packed into opening as a permanent form. Packing material to be recessed from top surface of floor to accommodate the required thickness of fill material.

B. **Fill, Void or Cavity Material\*** — Min 1/4 in. thickness of fill material applied within the joint, flush with top surface of floor.

**RECTORSEAL** — Biotherm 100, Biotherm 200 SL

\*Bearing the UL Classification Mark